

Complete and email this form with additional attachments to **design@closetmaid.com** or fax to **(352)629-4980**. Questions call **(800)874-0008**. Design will be emailed/faxed back within 48-72 hours. List price will be included.

Dealer name: _____ ClosetMaid customer #: _____ Date: _____

Contact person: _____ Project/Customer/Builder: _____

Phone: _____ Fax: _____ Email: _____

LAYOUT OPTIONS

Mark the layout of the closet using the options and design codes found on Page 3. Indicate all obstacles to be drawn around, and create elevation drawings of walls with windows and/or obstacles. **Please indicate all wall measurements accurately.** Dimensions affect pricing and cut lengths.

Provide material estimate for wire only.

Closet Layout

TOWER HEIGHT

85.625 in. 95.75 in.

Please provide DWG files on Multifamily, Hospitality, Single Family and Senior Housing projects.

WALL DIMENSIONS

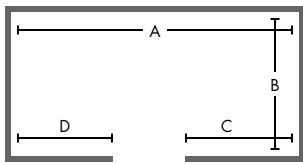

A: _____

B: _____

C: _____

D: _____

Wall Height: _____

Design it for me using the dimensions I've supplied.

Additional Notes

Please include any information that may help produce your design accurately. If more space is needed, include attachments (additional forms, sketches, etc...). List accessories (handle, hang rod, jewelry tray, etc...).

DESIGN OPTIONS

MasterSuite®

FINISH	DRAWER FRONT						MOUNTING OPTIONS	
	Classic (VINYL-WRAPPED)			27Th Avenue				
	MODERN	SHAKER	TRADITIONAL RAISED PANEL	MODERN	5-PIECE SHAKER	5-PIECE TRADITIONAL	HARDWARE FINISH	
White								Floor mount Wall mount
Antique White								
Chocolate Pear								
Coastal Gray								
Timeless Taupe								Chrome Oil-rubbed bronze
Clean Slate								
Washed White								
Natural Blonde								
Modern Gray								
Deep Blue								

ExpressShelf™

SHELF		HARDWARE				
TYPE	FINISH	TYPE	FINISH			
			WHITE	BLACK	CHROME	CHOCOLATE PEAR
12 in. Laminate ¹	White	Backwall Channel				
14 in. Melamine	Antique White	Sidewall Bracket				
12 in. Ventilated Wood ²	Chocolate Pear	Angle Bracket				
14 in. Ventilated Wood ²	Coastal Gray	Universal Pole Cups				
WIDTH	Timeless Taupe	Closet Rod				
	Clean Slate	Shelf Trim				
Please specify.	Washed White	Shelf End Caps				
	Natural Blond					
	Modern Gray					

Wire

SHELVING TYPE (shelf depths)	FINISH		SHELF DEPTH	MOUNTING OPTIONS
	WHITE	SATIN CHROME		
Shelf and Rod (S&R) (10 in., 12 in., 16 in.)		³		Fixed mount ShelfTrack®
Linen (6 in., 9 in., 20 in.)				
SuperSlide® (12 in., 16 in.)				
TotalSlide® (12 in., 16 in.)				
TotalSlide® Pro (12 in., 16 in.)				
Close Mesh (9 in., 12 in., 16 in., 20 in.)		⁴		
Heavy Duty (12 in., 16 in.)				

¹ Available in White only.

² Available in White and Chocolate Pear only.

³ Satin Chrome available in 10 in. and 16 in. only.

⁴ Satin Chrome available in 12 in. and 16 in. only.

LEGEND

Melamine Tower Configurations

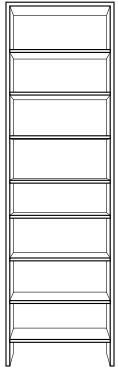

A



B



C



D

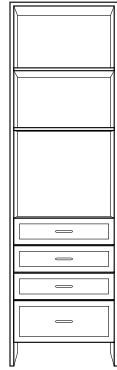

E



F



G



H



I



J



K

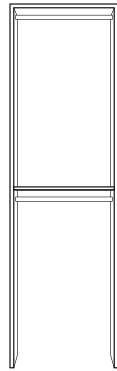

DH

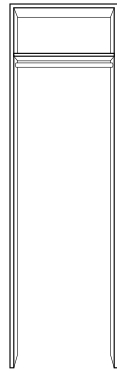

LH

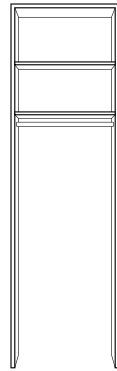

MH

Wire Configurations



1

2

3

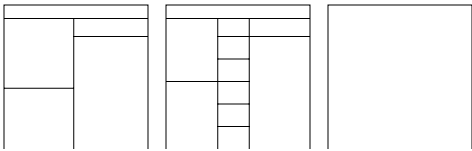

4

5

6

Please indicate layout for option 6.

Design Codes

