



Yale® Assure Lock™ Interconnected Locksets





Yale® Assure Lock™ Interconnected Locksets

FEATURES

- 12 lever designs and 3 finishes
- Available in push button, touchscreen or key free
- 4" or 5-1/2" center to center
- ANSI/BHMA A156.12 Grade 2 certified
- Available with fixed core or SFIC
- Field reversible handing
- Three year warranty on mechanical operation. One year on finish and electronics.



Exterior

Yale Real Living
Assure Lock™ Interconnected
Push Button



Exterior

Yale Real Living
Assure Lock™ Interconnected
Touchscreen



Exterior

Yale Real Living
Assure Lock™ Interconnected
Key Free Touchscreen



Interior

SPECIFICATIONS

Door Specs:	2-1/8" (54mm) Face Bore, 1" (25mm) Edge Bore, 4" (102mm) or 5-1/2" (140mm) Center to Center
Backset:	2-3/8" (60mm) or 2-3/4" (70mm)
Door Thickness:	1-3/8" (35mm) to 1-3/4" (44mm)
Handing:	Field Reversible
Latch Faceplate:	1" (25mm) W x 2-1/4" (57mm) H; Radius Corner standard
Strike:	2-1/4" (57mm) Full Lip Lockset and 1" (25mm) W x 2-1/4" (57mm) H Deadbolt; Radius Corner standard, other strikes available to order.
Cylinder:	KW-1 Compatible standard, other cylinders/keyways available to order
Keying:	KD (Keyed Different) standard, master keying available to order
Packaging:	Box Pack
ANSI/BHMA:	Certified ANSI/BHMA A156.12, Grade 2
UL/cUL:	Listed for 20 minute fire doors
Warranty:	Three years mechanical operation, one year finish and electronics



APPLICATIONS

- ▶ Multi-family residences
- ▶ Assisted living facilities
- ▶ Public restrooms
- ▶ Offices and small business applications



Yale® Assure Lock™ Interconnected Locksets

STYLES



YRC216

Passage with Push Button Keypad

- Uses Yale Real Living Assure Lock™ push button.
- Single point lock.
- Latchbolt is operated by either lever at all times.
- Deadbolt activated by electronic keypad interaction or by key outside; inside by T-turn.
- Interior lever retracts latch and deadbolt simultaneously.



YRC226

Passage with Touchscreen

- Uses Yale Real Living Assure Lock™ touchscreen.
- Single point lock.
- Latchbolt is operated by either lever at all times.
- Deadbolt activated electronic touchscreen interaction or by key outside; inside by T-turn.
- Interior lever retracts latch and deadbolt simultaneously.



YRC246

Passage with Key Free Touchscreen

- Uses Yale Real Living Assure Lock™ key free touchscreen.
- Single point lock.
- Latchbolt is operated by either lever at all times.
- Deadbolt activated electronic touchscreen interaction outside; inside by T-turn.
- Interior lever retracts latch and deadbolt simultaneously.
- Use a 9V battery backup on the outside as a override in case the batteries die.



FINISHES

ANSI/BHMA Code (US Designation) Finish Description

**605 (US3)
Bright Brass, Clear
Coated**



**619 (US15)
Satin Nickel Plated,
Clear Coated**



**(US10BP)
Oil Rubbed Bronze -
Permanent**





How To Order

Use this outline to build the model number for the Yale® Assure Lock™ Interconnected Lockset you require.

Style	Technology	Lever	Center to Center	Cylinder	Finish
YRC226 = Touchscreen	NR = No Radio	AC = Academy	4 - 4"	KA = KW Keyed alike	605 (US3) = Bright Brass Clear Coated
YRC216 = Pushbutton	ZW2 = Z-Wave	AU = Augusta	5 - 5-1/2"	SA = SC Keyed alike	619 (US15) = Satin Nickel Plated Clear Coated
YRC246 = Key Free Touchscreen	HA2 = ZigBee	DE = Delaware		KD = KW Keyed different	0BP (US10BP) = Oil Rubbed Bronze - Permanent
	CA2 = Control4	DE = Delaware		SD = SC Keyed Different	
	CR2 = Crestron	MC = McClure		PA = PARA keyed alike	
		MN = Milan		PD = PARA Different	
		MO = Monroe		SF = SFIC*	
		NW = Norwood			
		PB = Pacific Beach			
		VG = Virgo			
		VL = Valdosta			
		WL = Woodland			

*SFIC less cylinder

BUILD YOUR ORDER STRING

Quantity	Style	Technology	Lever	Center to Center	Cylinder	Finish
<i>Example:</i>	YRC226	ZW2	NW	4"	KA	619

Notes:

- Order the module compatible with your home or security automation system
- The Yale Real Living® Assure Lock™ Interconnected lock comes standard with three latches:
 - One adjustable backset deadbolt latch
 - One 2-3/8" backset lever latch
 - One 2-3/4" backset lever latch
 Non-standard latches must be ordered separately.
 All latches are radius corner.
- All master key, builder key or keyed alike requests must be added to the order as a note.



Dimensions/Exploded View

CENTER TO CENTER DIMENSIONS

All electronic locksets available as 4" or 5-1/2" center to center dimension. Must be ordered this way from the factory and are not field changeable.

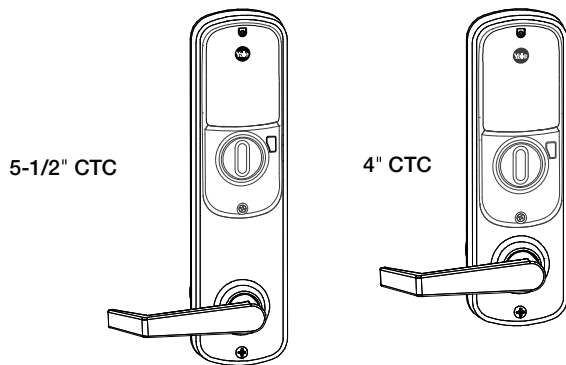

PRODUCT DIMENSIONS

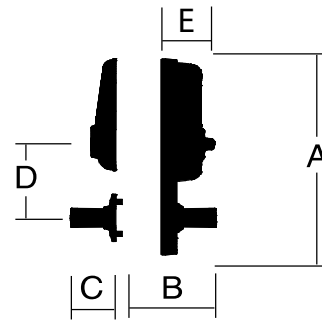

Dimensions				
A	B	C	D	E
10-5/8"	2-5/8"	2-1/2"	4"	2-13/16"
12-1/8"			5-1/2"	

ELECTRONIC

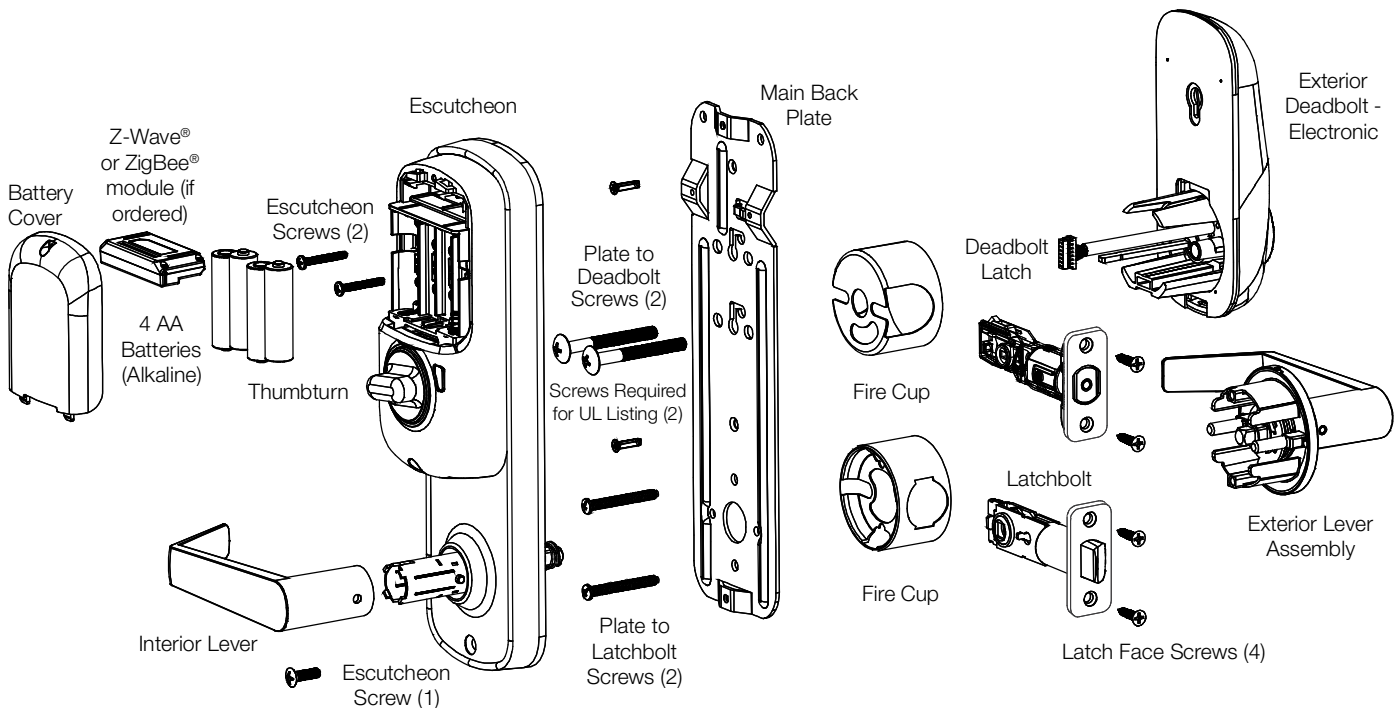



Sample Architectural Specification

All locksets shall be Yale Real Living® Assure Lock™ Interconnected Lever Locksets provided by Yale Locks & Hardware.

All locksets shall have a simultaneous retraction of latchbolt and deadbolt with a single motion of turning the lever handle.

Locks shall have an interlocking tubular chassis and latchbolt. Chassis mounting screws shall be concealed and accessible only when the levers and roses are removed.

The latchbolt shall have a 1/2" (13mm) throw and entry functions shall include a deadlocking feature to inhibit manipulation when the door is locked.

All locksets shall be adjustable for 1-3/8" (35mm) and 1-3/4" (51mm) door thickness.

All electronic locksets shall be available with either a 4" (102mm) or 5-1/2" (140mm) center to center dimension.

Levers shall operate independently and shall have inside and outside lever return springs to prevent lever sag.

All locksets shall include an electronic cylindrical deadbolt.

All locksets shall be furnished with two keys. All cylinder plugs shall be brass and have master keying capabilities.

All lockset shall be furnished in standard ANSI/BHMA architectural finishes.

Certification:

ANSI/BHMA A156.12, Grade 2

UL/cUL 1-1/2 Hour Fire Rating

ANSI A117.1 Accessibility Code

All locksets shall carry a three-year mechanical and one year electronic warranty.



Interconnected Lock Lever Selection

LEVERS



<p>ACADEMY (AC)</p> 	<p>AUGUSTA (AU) Formerly Citadel (CD)</p> 	<p>DELAWARE (DW)</p> 	<p>MARINA (MA)</p> 
<p>McCLURE (MC)</p> 	<p>MONROE (MO) Formerly Meridian (ME)</p> 	<p>MILAN (MN)</p> 	<p>NORWOOD (NW)</p> 
<p>PACIFIC BEACH (PB) Formerly Cascade (CS)</p> 	<p>WOODLAND (WL)</p> 	<p>VALDOSTA (VL)</p> 	<p>VIRGO (VG)</p> 

Roses only as shown

 Levers available with small format interchangeable core (SFIC) prep x less core. Available for mechanical function YR872 only.

SPECIFY LEVER SELECTION

Electronic and Mechanical Interconnected products ship with standard lever "Norwood" unless otherwise specified on order.





Cylinders

FIXED CORE

Lock Type	Keyway	Description	Model Number		Number of Pins
			Lockset	Deadbolt	
Mechanical	Kwikset®	Standard cylinder. Available 1-bitted, KA, KD (std), MK, BK	YR06D013 (605) YR06D016 (626)	YR06D103ICN (605) YR06D106ICN (626)	6
	Yale® PARA	Optional cylinder. Available 0-bitted, KD, KA, MK, BK	YR06Y303 (605) YR06Y306 (626)	YR06Y413ICN (605) YR06Y416ICN (626)	6
	Yale® GA	Optional cylinder. Available 0-bitted, KD, KA, MK, CMK	1803-54K	1803-134S	6
	Arrow AR	Optional cylinder. Available KA, KD	100YC	692C	6
	Schlage® C	Optional cylinder. Available 0-bitted, KD, KA, MK, BK	YR068D01 (605) YR068D05 (626)	YR068D02ICN (605) YR068D06ICN (626)	6
Electronic	Kwikset®	Standard cylinder. Available KA, KD (std), MK	N/A	AYRD200-KW	5
	Yale® PARA	Optional cylinder. Available 0-bitted, KD, KA, MK, BK	N/A	AYRD200-PA	6
	Schlage® C	Optional cylinder. Available 0-Bitted, KA, KD, MK	N/A	AYRD200-SC	5

Note: Other Yale Commercial keyways and cylinder mechanisms available separately. Contact customer service for availability.
605 finish cylinders used with 605, 613E and 10BP finish locks.
626 finish cylinders used with 619 and 626 finish locks.
Specify finish and keying when ordering.

INTERCHANGEABLE CORE

Small Format

Small format interchangeable core is available.

To order, specify "x SFIC-LC" for cylinder. i.e. AU x YR852 x SFIC-LC x 4" x 626

For entry functions, SFIC is available with for AU, MO and PB designs only. Mechanical only.

All units will be provided less core. Model number A600 or K600 cores can be ordered separately through Yale Commercial.

Large Format (Mechanical Only)

Yale Commercial large format interchangeable core is available for passage function.

To order, specify "x LFIC-LC" for cylinder. i.e. AU x YR852 x LFIC-LC x 4" x 626

All units will be provided less 6-pin core only. LFIC cores can be ordered separately through Yale Commercial.



Latchbolts

LOCKSET LATCHES

Passage (single keyed), privacy and electronic locks supplied with plain (spring) latchbolts. Entry (double keyed) supplied with deadlocking latchbolts.

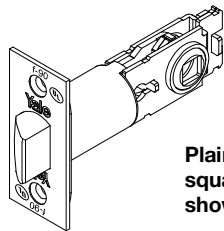

**Plain (Spring)
square corner
shown.**

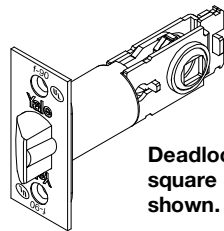

**Deadlocking
square corner
shown.**

Plain (Spring)

Model No.	Front	Backset	Front Width	Throw	Latch Diameter**
YR01802*U	Radius	2-3/8" (60mm)	1" (25mm)	1/2" (13mm)	7/8" (22mm)
YR01804*U	Square	2-3/8" (60mm)	1" (25mm)	1/2" (13mm)	7/8" (22mm)
YR01806*U	Radius	2-3/4" (70mm)	1" (25mm)	1/2" (13mm)	7/8" (22mm)
YR01808*U	Square	2-3/4" (70mm)	1" (25mm)	1/2" (13mm)	7/8" (22mm)

Used with YR852, YR853, YRC216, YRC226, YRC246.

Deadlocking

Model No.	Front	Backset	Front Width	Throw	Latch Diameter**
YR01812*U	Radius	2-3/8" (60mm)	1" (25mm)	1/2" (13mm)	7/8" (22mm)
YR01814*U	Square	2-3/8" (60mm)	1" (25mm)	1/2" (13mm)	7/8" (22mm)
YR01816*U	Radius	2-3/4" (70mm)	1" (25mm)	1/2" (13mm)	7/8" (22mm)
YR01818*U	Square	2-3/4" (70mm)	1" (25mm)	1/2" (13mm)	7/8" (22mm)

Used with YR872.

Note: All latchbolts are only available with flat fronts, not recommended for beveled doors. 1-1/8" latch filler provided.

*Specify finish when ordering "3" for 605; "6" for 619, 626; "B" for 10BP; "C" for 613E.

**1/8" sleeve (P/N YR035110) supplied with all latchbolts to accommodate 1" preps.



Latchbolts

DEADBOLT LATCHES

For mechanical locksets with Yale® PARA, KW1 and Schlage® C keyway cylinders and all electronic locksets, adjustable backset deadbolt latches are standard. For all other cylinder types, backset must be specified.

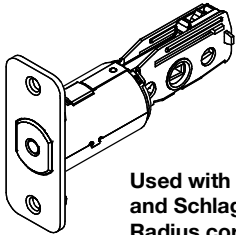

Used with Yale PARA, Kwikset and Schlage C Keyway Cylinders. Radius corner shown.

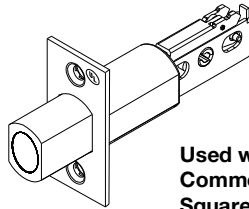

Used with SFIC, Arrow and Yale Commercial Keyway Cylinders. Square corner shown.

Mechanical

Model No.	Front	Backset	"W" Front Width	Throw
YR01D44*U	Square	Adjustable^	1" (25mm)	1" (25mm)
YR01D41*U	Radius	Adjustable^	1" (25mm)	1" (25mm)

For use with Yale PARA, Kwikset and Schlage C keyway cylinders

D38	Square	2-3/8" Fixed	1" (25mm)	1" (25mm)
D38R	Radius	2-3/8" Fixed	1" (25mm)	1" (25mm)
D34	Square	2-3/4" Fixed	1" (25mm)	1" (25mm)
D34R	Radius	2-3/4" Fixed	1" (25mm)	1" (25mm)

For use with SFIC, Arrow and Yale Commercial keyway cylinders.

Electronic

Model No.	Front	Backset	"W" Front Width	Throw
AYRDB	Radius	Adjustable^	1" (25mm)	1" (25mm)

Screw packs not provided for latchbolts ordered separately.

*Specify finish when ordering "3" for 605; "6" for 619, 626; "B" for 10BP; "C" for 613E.

^Adjustable between 2-3/8" and 2-3/4".



Strikes

Yale® interconnected locks are available with a variety of strike options. All strikes are located on the same vertical and horizontal center lines as the latchbolt and deadbolt. All strikes are reversible. Strikes are fabricated of either brass, bronze or stainless steel, depending on the lockset trim finish. When ordering strikes separately, please specify the finish required.

LOCKSET

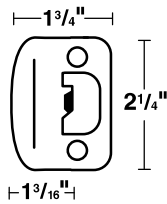

Model No. YR02000* Full Lip Strike Radius Corner
Standard strike supplied with all units. Plastic strike dust box available separately.

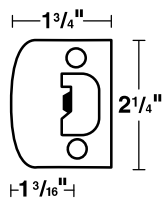

Model No. YR02001* Full Lip Strike Square Corner
Optional strike available. Plastic strike dust box available separately.

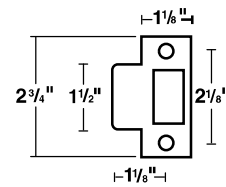

Model No. YR02020* T-Strike
Optional strike available. Plastic strike dust box available separately.

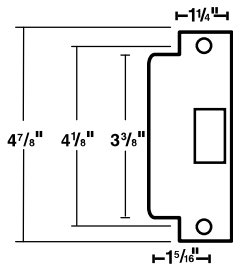

Model No. YR02030* ANSI 4-7/8 Strike with Screw Pack
Optional strike available. Plastic strike dust box available separately.

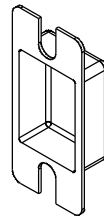

Model No. YR026003 Plastic Strike Dust Box
Available separately.

DEADBOLT

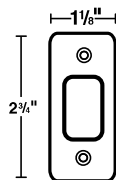

Model No. YR02088* Universal Deadbolt Strike Radius Corner
Standard strike supplied with all mechanical units. Plastic strike dust box available separately.

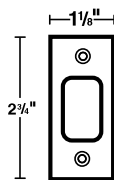

Model No. YR02086* Universal Deadbolt Strike Square Corner
Optional strike available for all mechanical units. Plastic strike dust box available separately.

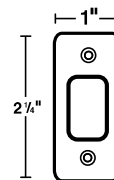

Model No. AYRD-SCREW* Deadbolt Strike Radius Corner with Screw Pack
Standard strike supplied with all electronic units.

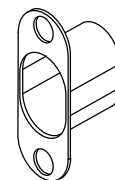

Model No. YR026002 Plastic Strike Dust Box
Available Separately.

Note: See Yale Residential price catalog for additional optional deadbolt strikes.

*Specify finish when ordering “3” for 605; “6” for 619, 626; “B” for 10BP; “C” for 613E.
Screw packs not provided for strikes ordered separately unless indicated.

Contact Us

U.S.A.

Yale Locks & Hardware

Address: 225 Episcopal Road
Berlin, CT 06037-4004
Tel: 1-800-438-1951
Fax: 1-800-338-0965
yalelocks.com

Canada:

ASSA ABLOY Door Security Solutions Canada

Address: 160 Four Valley Drive
Vaughan, Ontario L4K 4T9
Tel: 1-800-461-3007
Fax: 1-800-461-8989
assaabloy.ca

The world's favorite lock



International:

ASSA ABLOY Americas International

Tel: 1-905-821-7775
Fax: 1-905-821-1429
assaabloyai.com

Yale Locks & Hardware is a division of Yale Security Inc., an ASSA ABLOY Group company.

Yale® and Yale Real Living® are registered trademarks of Yale Security Inc., an ASSA ABLOY Group company. Assure Lock™ and YH Collection™ are trademarks of Yale Security Inc., an ASSA ABLOY Group company. Other products' brand names may be trademarks or registered trademarks of their respective owners and are mentioned for reference purposes only. These materials are protected under U.S. copyright laws. All contents current at time of publication. Yale Security, Inc. reserves the right to change availability of any item in this catalog, its design, construction, and/or its materials. Copyright © 2016-2017, Yale Security Inc., an ASSA ABLOY Group company. All rights reserved. Reproduction in whole or in part without the express written permission of Yale Security Inc., an ASSA ABLOY Group company is prohibited.

YALE, with its unique global reach and range of products, is the world's favorite lock.

ASSA ABLOY is the global leader in door opening solutions, dedicated to satisfying end-user needs for security, safety and convenience.

099360-9/17E